

PLAT MAP OF NEW MEADOWS

Civil Engineer Lee Highley for the Coeur d'Or Development Company

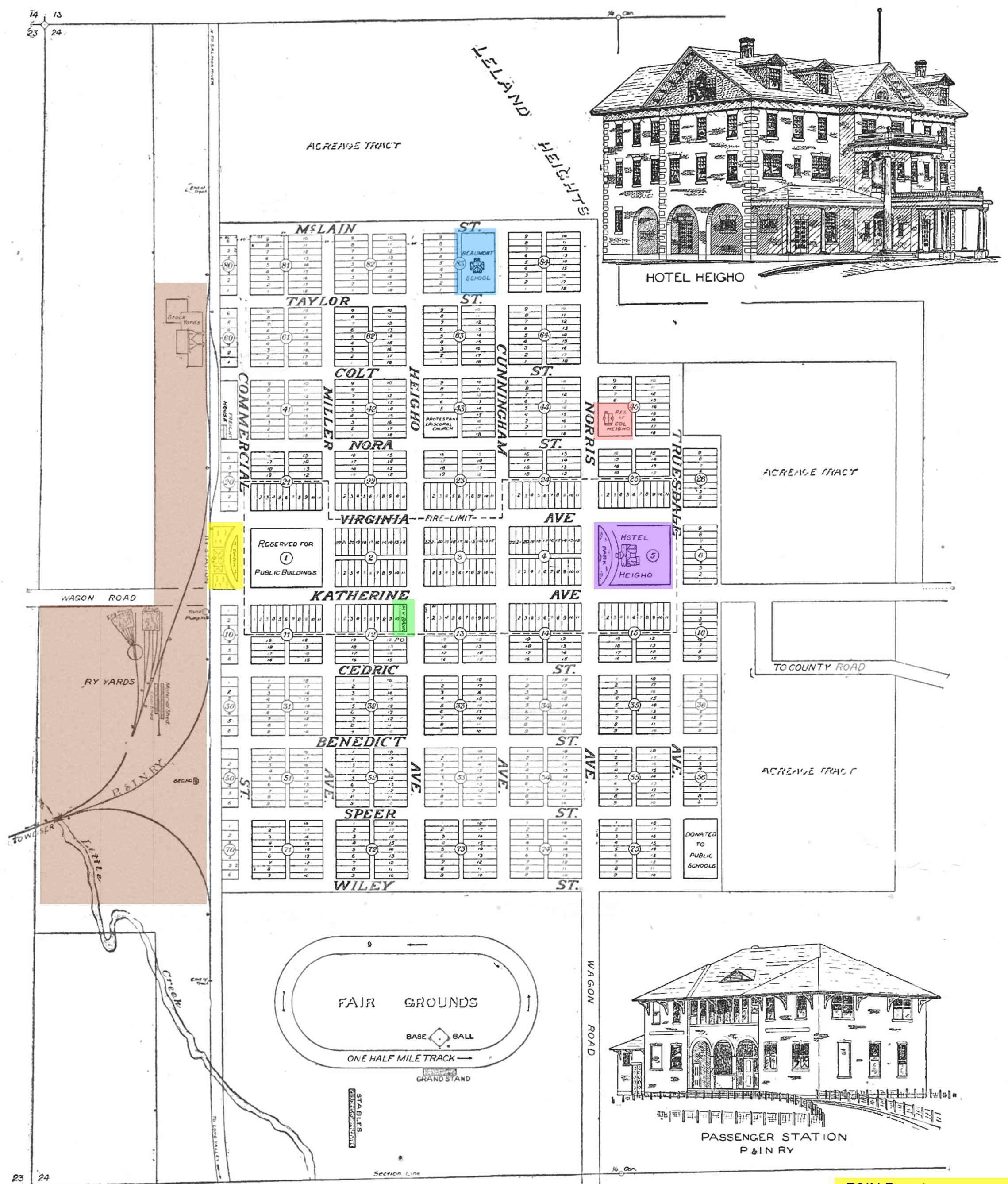

NEW MEADOWS TOWNSITE ADAMS COUNTY IDAHO

COEUR D'OR DEVELOPMENT CO.
E. M. HEIGHO PRESIDENT
—1911—

With the Plat map* in place, Colonel Edgar Heigho proceeded to have the P&N Railway Depot built and ready for business by January 29, 1911. Other major brick buildings that were quickly built were the 53 room Hotel Heigho, Beaumont School, and the bank. Some streets were named after Col. Heigho's family members: Virginia and Katherine Avenues (twin daughters), Cedrick St. (son), Nora Street (wife), and Heigho Avenue after the Colonel.

*When a development is created a Plat map is drawn by a civil engineer. It is an official document approved by governing county. The Plat map is drawn to scale and records the land's size, boundary locations, nearby streets, flood zones, and any easements or rights of way.

